



**EIBENSTOCK**  
Elektrowerkzeuge



# Renovation professionals

Removal of old materials and  
preparation of surfaces

# YOUR SCOPE OF APPLICATION

	suitable for illustrated area ratios				
		concrete	screed	tile adhesive	natural stone
<b>EOF 100.1</b>					
<b>EPF 1503</b>		5	5	$\frac{3}{5}$	
<b>EBS 120.1</b>		$\frac{6}{7}$	8	8	
<b>EBS 125.4 O EBS 125.4 RO</b>		$\frac{6}{7}$	8	8	
<b>EBS 1802 EBS 1802 SH</b>		$\frac{6}{7}$	8	8	$\frac{13}{14}$
<b>EBS 180 H EBS 180 F</b>		15	16	16	17
<b>EBS 235.1</b>		18	19* *limited suitability	19* *limited suitability	19
<b>ELS 125 D</b>		$\frac{22}{23}$		23	





milling disc Ø 100 mm

- |                                   |                 |
|-----------------------------------|-----------------|
| 1 PCD, round segments             | <b>37125000</b> |
| PCD, pointed segments             | <b>37116000</b> |
| 2 Carbide                         | <b>37124000</b> |
| Claw cutters                      |                 |
| 3 bent, 16 pieces                 | <b>37426000</b> |
| 4 pointed, 16 pieces              | <b>37427000</b> |
| 5 Diamond-grinding wheel Ø 150 mm | <b>37127000</b> |

\*Accessories required - see back page

Diamond-grinding wheel Ø 125 mm

- |  |                 |
|--|-----------------|
| 6 concrete standard                                  | <b>37114000</b> |
| 7 concrete premium (not illustrated)                 | <b>37102000</b> |
| 8 screed   | <b>37103000</b> |
| 9 coatings „Rapid K“                                 | <b>37110000</b> |
| Tungsten carbide grit disc Ø 125 mm für EBS 125.4 RO |                 |
| 10 rough   | <b>37107000</b> |
| 11 medium (not illustrated)                          | <b>37106000</b> |
| 12 fine (not illustrated)                            | <b>37108000</b> |

					
plaster soft	plaster hard	paintings	coatings	carpet adhesive	wood
		1 	1 		2 
3 	$\frac{4}{5}$ 	4 	3 		
	8 	9 	9 	9 	
$\frac{10}{11}$ $\frac{12}{12}$ 	8 	9  10 	9 	9 	$\frac{10}{11}$ $\frac{12}{12}$ 
 $\frac{13}{14}$	8   $\frac{13}{14}$	9   $\frac{13}{14}$	9   $\frac{13}{14}$	9   $\frac{13}{14}$	
 17	16   17	 17	 17	 17	
		19 	19 	19 	
	23 	23 			

PCD-grinding wheel Ø 125 mm

13 pointed segments **37115000**

14 round segments (not illustrated) **37118000**

Diamond-grinding wheel Ø 180 mm

15 concrete **37112000**

16 screed **37111000**

17 PCD-grinding wheel Ø 175 mm round segments **37119000**

18 Diamond-grinding wheel Ø 235 mm, concrete **37117000**

19 PCD-grinding shoe set, 5 parts with support segment, round segments **37121000**

Diamond-grinding shoe set, 5 parts

20 concrete **37122000**

21 screed **37123000**

Diamond-grinding wheel Ø 125 mm

22 surface grinding **37126000**

23 universal **37128000**



# SURFACE MILLING MACHINE

EOF 100.1 – Strong performance with low weight



**Turnable protection guard with dust extraction**  
flexible adaptation to the surface to be finished  
especially in edges

Ø 100

**Soft grip handle**

less vibration

**Spindle lock**

easy change of the disc



**Support plate**

easy guiding, no tilting of the machine



**Extraction nozzle**

Ø 35 mm

Direct connection of an  
EIBENSTOCK dust class M  
Vacuum Cleaner

## Sanding was yesterday - Fine Milling is today



**Precision hood: depth adjustment in 0.1 mm steps for exact removing (up to max. 1.0 mm) – no unintentional milling into the basic material**

**TIME AND MATERIAL SAVING** compared to alternative methods

-> easy and economical working

-> saves about 2/3 of the working time



no hazardous  
chemical substances



no unhealthy  
persistent odors



no clogging of  
the abrasive



# SCABBLER AND SCOURING MACHINE

EPF 1503 – The universal with a high removal rate



Claw cutters bent  
for lime-bound soft plaster



Claw cutters pointed  
for cement-bound hard plaster



Ø 140



now available for use with  
diamond-grinding wheel Ø 150 mm\*

Guide ring adjustable  
precise depth definition

Brush rim  
Protection against  
dust



Extraction nozzle  
Ø 35 mm  
Direct connection of an EIBENSTOCK  
dust class M Vacuum Cleaner

Soft grip handle  
less vibration

\* Accessories required - see back page



# THE COMPACT CONCRETE GRINDER

EBS 120.1 – for small areas and limited spaces



Dust guard  
Foldable front edge – grinding directly  
to the edge of the  
work area



Ø 125



Brush rim  
Protection against dust



Extraction nozzle Ø 35 mm  
Direct connection of an EIBENSTOCK  
dust class M Vacuum Cleaner

Soft grip handle  
less vibration



# CONCRETE GRINDER WITH PARALLEL HANDLE POSITION

## Arrangement of motor

vertical – dust is kept away, durable

## Motor cooling

Air is sucked outside of the dust area  
- increasing the life time

## Parallel handle position

ergonomic handles allow  
exact and balanced  
guiding for a better surface  
finish

## Vibration damping

splitting between motor and handle (patented)  
– efficient vibration absorption, protects the  
wrists of the user, better grinding performance



## Brush rim

protection against  
dust emission

## Extraction nozzle Ø 35 mm

direct connection of an EIBENSTOCK  
dust class M Vacuum Cleaner



## Dust guard

foldable front edge  
(EBS 180 H: removable  
segment) – to get to the  
edge of the working area

## Our recommendation:

**One for almost everything: PCD-grinding  
wheel with monobloc diamonds**  
– high removal rate and long lasting  
(accessory for EBS 1802 and EBS 180)

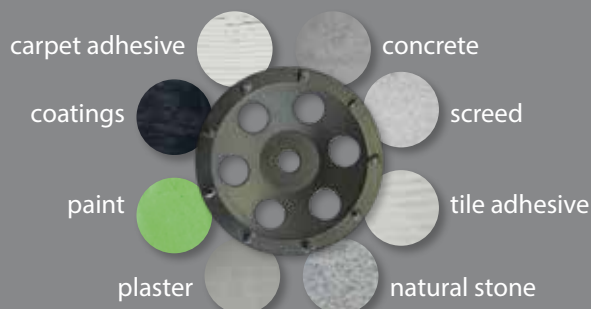



Ø 125



**EBS 125.4 O**  
The robust entry-level  
model



**EBS 125.4 RO**  
with speed regulation



Adaptation of the speed  
on soft surfaces and for  
use with tungsten carbide  
grinding discs



Ø 125



**EBS 1802**  
The powerful concrete  
grinder



**EBS 1802 SH**  
The powerful with PCD  
grinding wheel

up to 3 times higher  
grinding performance and  
10 times longer life time



Ø 180



**EBS 180 H**  
The powerful for high  
area performance



# CONCRETE GRINDER WITH FLOOR GUIDING DEVICE

EBS 180 F



**Dust guard**  
Removable segment -  
work close to the edge



Relaxed work in an upright  
posture

Ø 180

**Brush rim**  
protection against dust emission



**Extraction nozzle Ø 35 mm**

direct connection of an  
EIBENSTOCK dust class M  
Vacuum Cleaner

**Tilt-adjustable floor guiding  
device and additional handle  
adjustable in height**

optimal adjustment to the body  
height of the operator for a  
comfortable guiding

**Motor arrangement**

vertical in a low dust zone,  
long lifetime

**Carriage adjustable in  
height**

better grinding result

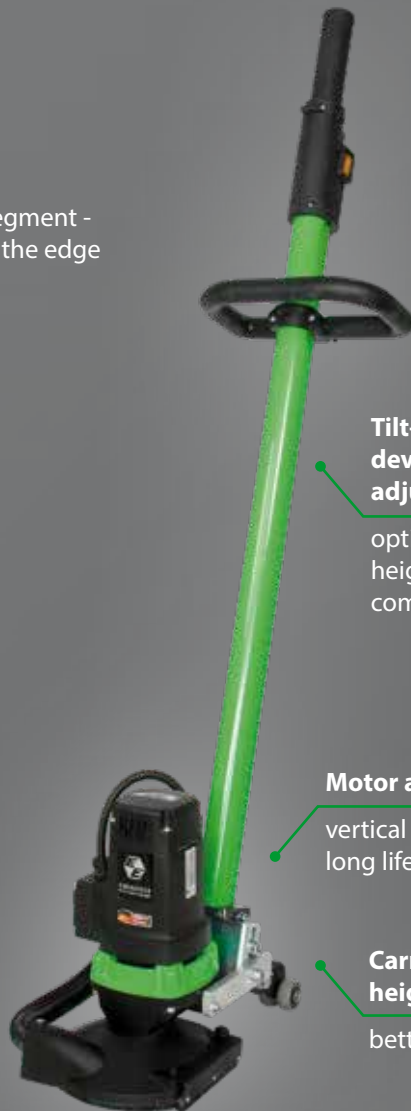



# CONCRETE GRINDER WITH FLOOR GUIDING DEVICE

EBS 235.1



**BACK  
PROTECTION  
SYSTEM**

Ergonomics in Construction

Relaxed work in an upright posture



**Segment on the dust-guard detachable and adjustable handle –**  
for grinding directly to the edge of the work area

**Tilt-adjustable floor guiding device**

optimal adjustment to the body height of the operator for a comfortable guiding

**Brush rim**

protection against dust emission



**Extraction nozzle Ø 35 mm**

direct connection of an EIBENSTOCK dust class M Vacuum Cleaner

**Carriage adjustable in height**

better grinding result

Ø 235

**Low weight and additional handle on the motor**

easy transport

**Motor arrangement**

vertical in a low dust zone, long lifetime



**base plate for use with interchangeable diamond grinding shoes (accessory):**

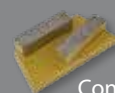

Concrete



PCD

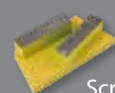

Screed



**Choose and order also the appropriate grinding shoes for your application!**

# LONG REACH RENOVATION GRINDER

ELS 125 D for wall and ceiling



**Dust guard**  
foldable segment - work  
close to the edge

**Robust joint**  
optimal adaptation to  
inclination and angle

**height adjustable  
additional handle**

optimal adaptation to  
the size of the user -  
comfortable guiding

**Locking for suction hose**

avoids unintentional loosening of  
the hose during grinding

Ø 125

**Brush rim**  
Protection against dust



**Extraction nozzle Ø 35 mm**  
Direct connection of an  
EIBENSTOCK dust class M  
Vacuum Cleaner



## Flexible drive shaft:

can be changed easily,  
quickly and inexpensively  
by the user without  
opening the machine



**Diamond-grinding wheel**  
Ø 125 mm (Accessory)

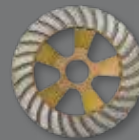

surface grinding  
for concrete





Universal for  
concrete, Tile  
adhesive, plaster



incl. practical transport bag



	Ø 100	Ø 140/150	Ø 125	Ø 125	Ø 125
					
	Eof 100.1	EPF 1503	EBS 120.1	EBS 125.4 0	EBS 125.4 R0
Power input	1400 W	1500 W	1400 W	1500 W	1500 W
Rated voltage	230 V~	230 V~	230 V~	230 V~	230 V~
Rated speed	10000 rpm	4000 rpm		10000 rpm	6000-10.00 rpm
No-load speed			9000 rpm		
Disc diameter	100 mm	140 mm/150 mm	125 mm	125 mm	125 mm
Milling depth	0,1-1,0 mm	0,5-4,0 mm			
Spindle connection	Ø 22.2 mm	M 14 male/Ø 22.2 mm	Ø 22.2 mm	Ø 22.2 mm	Ø 22.2 mm
Elektronic					
Soft start	•	•		•	•
Temperature control	•	•		•	•
Over current cut-off		•		•	•
Overload indication					
Speed regulation					•
Constant speed	•	•		•	•
Speed reduction in case of overload		•		•	•
Spindle lock	•		•		
Locking for suction hose					
Floor guiding device				• (accessory)	• (accessory)
Weight	3,4 kg	3,9 kg	3,5 kg	4,7 kg	4,7 kg
Order no.	06535000	06511000	0630F000	06324000	06325000
Supplied	in a case incl. assembly tools, without milling disc	in a case incl. capstan with 16 claw cutters (bent)	in a case incl. diamond-grinding wheel (concrete) and assembly tools	in a case incl. diamond-grinding wheel (concrete) and assembly tools	in a case incl. diamond-grinding wheel (concrete) and assembly tools

	Ø 125	Ø 180	Ø 180	Ø 235	Ø 125
					
	EBS 1802/EBS 1802 SH	EBS 180 H	EBS 180 F	EBS 235.1	ELS 125 D
Power input	1800 W	2500 W	2500 W	2200 W	1200 W
Rated voltage	230 V~	230 V~	230 V~	230 V~	230 V~
Rated speed					8000 rpm
No-load speed	10000 rpm	8500 rpm	8500 rpm	1380 rpm	
Disc diameter	125 mm	180 mm	180 mm	235 mm	125 mm
Milling depth					
Spindle connection	Ø 22.2 mm	Ø 22.2 mm	Ø 22.2 mm	M 20 male/Special	Ø 22.2 mm
Elektronic					
Soft start	•	•	•		•
Temperature control		•	•		•
Over current cut-off	•	•	•		•
Overload indication	•				
Speed regulation					
Constant speed					•
Speed reduction in case of overload					
Spindle lock					
Locking for suction hose		•			•
Floor guiding device	• (accessory- not for SH)		•	•	
Weight	5,9 kg	8,4 kg	10,5 kg	38,0 kg	5,3 kg
Order no.	0633J000/0633L000	0633H000	0634H000	06347000	06231000
Supplied	in a case incl. diamond-grinding wheel (concrete)/PCD-grinding wheel and assembly tools	in a case incl. diamond-grinding wheel (concrete) and assembly tools	in a box incl. diamond-grinding wheel (concrete) and assembly tools	in a box incl. base plate for diamond-grinding shoe set	in a box incl. transport bag, diamond-grinding wheel universal and assembly tools



# EIBENSTOCK

## Elektrowerkzeuge

**PROFESSIONAL**  
**GERMAN** SINCE 1919  
**POWER TOOLS**

## FURTHER ACCESSORIES

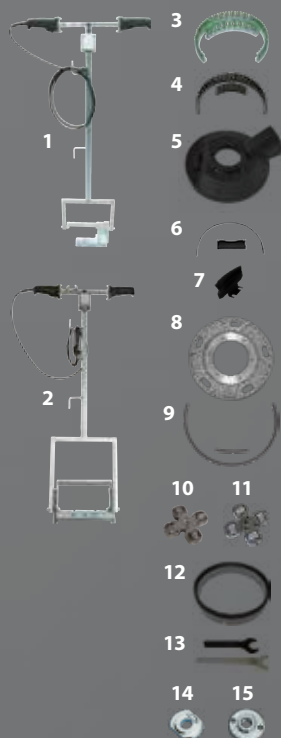

	EPF 1503	EB 120.1	EB 125.4 O	EB 125.4 RO	EB 1802	EB 1802 SH	EB 180 H	EB 180 F	EB 235.1	EL 125 D	
1 Floor guiding device	•										37404000
2 Floor guiding device			•	•	•						37212000
3 Brush rim, 2 parts (for dust guard with detachable segmet no.37205000))			•	•	•	•					37202000
4 Brush rim, 2 parts (for dust guard with flip segmet no 37229000)		•	•	•	•	•				•	3722A000
5 Dust guard with flip segmet (cpl. with brush rim and wrench)		•	•	•	•	•					37229000
6 Brush rim, 2 parts							•	•			37227000
7 Segment for dust guard									•		37226000
8 Base plate for grinding shoes									•		37120000
9 Brush rim, 2 parts									•		37224000
10 Capstan with 16 claw cutters (bent)	•										37428000
11 Capstan with 16 claw cutters (pointed)	•										37429000
12 Brush rim	•										37425000
13 Tool kit for changing the capstan	•										37416000
14 Driving disc, M 14	•										37206000
15 Driving nut, M 14	•										37207000

For the conversion of the EPF 1503 to use with a diamond grinding disc you will need:  
1x 37416000 Tool kit, 1x 76301927 wrench SW 32,  
1x 37206000 Driving disc, M 14, 1x 37207000 Driving nut, M 14

Furthermore, we recommend an EIBENSTOCK industrial vacuum cleaner of dust class M:



Specifications	DSS 25 M	DSS 35 M iP
Max. power input	1400 W	1600 W
Rated voltage	230 V~	230 V~
Tank volume (max.)	25 l (gross)	35 l (gross)
Dust volume	20 l (net)	25 l (net)
Air flow	max. 73 l/s	max. 75 l/s
Vacuum	max. 270 mbar	max. 280 mbar
Weight	12.7 kg	15.0 kg
<b>Order no.</b>	<b>09917000</b>	<b>09919000</b>
Supplied	in a box incl. accessories	in a box incl. accessories

Elektrowerkzeuge GmbH Eibenstock  
Auersbergstraße 10  
08309 Eibenstock, Germany

Phone: +49 (0) 3 77 52 - 50 30  
Fax: +49 (0) 3 77 52 - 20 19  
Internet: [www.eibenstock.com](http://www.eibenstock.com)  
E-Mail: [office@eibenstock.com](mailto:office@eibenstock.com)

Certified according to DIN EN ISO 9001:2015  
Technical changes excepted! Illustrations may vary!

Your distributor: